



## **TOYOTA HILUX LEGEND** **FITMENT INSTRUCTION**

- STEP 1:** REMOVE STANDARD BUMPER AND PLASTIC SIDE BRACKETS. **REMEMBER TO RE-INSTALL FACTORY SCREWS WITH PROVIDED (M6 x 20mm WASHER) BACK INTO THE BUMPER RAIL TO TIGHTEN THE MAIN LIGHTS.**
- STEP 2:** BOLT MAIN MOUNTING ONTO VEHICLE CHASSIS AND CENTER MAIN MOUNTING. FIT THE LEFT AND RIGHT SIDE BRACKETS ONTO THE MAIN MOUNTING.
- STEP 3:** WHEN BRACKET SYSTEM IS BOLTED INTO POSITION SLIDE THE BULLBAR OVER THE MAIN MOUNTING.
- STEP 4:** MAKE SURE BULLBAR IS LEVEL AND EVENLY SPACED LEFT AND RIGHT. MAKE SURE THERE IS A MIN GAP OF 14mm ON THE POINTS SHOWN IN **FIG A** ON PAGE 4 (MEASURE WHERE RUBBER STOPPES). A MIN 20mm GAP BETWEEN BODY AND BUMPER AS SHOWN IN POSITION **FIG B** ON THE DRAWING (RUBBER FILLES GAP). MAKE SURE THERE IS A SUFICIENT GAP BETWEEN RUBBER AND HEADLIGHTS TO PREVENT CHAVING ON THE HEADLIGHT SHOWN IN **FIG C**.
- STEP 5:** SCRIBE HOLES ONTO MAIN MOUNTING AND BULLBAR. TAKE BULLBAR OFF AND DRILL  $\varnothing$  10.5 HOLES IN SCRIBED LOCATION.
- STEP 6:** CLEAN THE SURFACE ON THE LEFT AND RIGHT FENDER WITH THE PROVIDED HI-CARE WIPES. ATTACH RUBBER TO FENDER, DO NOT CUT RUBBER TRIM UNTIL BULLBAR IS FULLY FITTED.
- STEP 7:** SLIDE RUBBER ONTO BULLBAR TO COVER CLEARANCE BETWEEN BODY AND BULLBAR.
- STEP 8 :** MARK THE POSITION (LEFT/RIGHT) AND DIRECTION IN WHICH THE PDC SENSOR IS POSITIONED BEFORE REMOVING OUT OF STANDARD BUMPER PLACE PDC SENSOR IN RUBBER GROMMET PUSHING THE SENSOR GENTLY UNTILL IT REACHES THE RECESS IN THE GROMMET.
- STEP 9:** SLIDE BULLBAR BACK INTO POSITION AND BOLT BULLBAR DOWN USING ALL THE MAIN MOUNTING AND LOCATION HOLES.
- STEP 10:** BOLT THE LEFT AND RIGHT INNER FENDER SUPPORT BRACKER ON TO THE LEFT AND RIGHT SIDE BRACKETS.
- STEP 11:** WHEN BULLBAR IS IN POSITION THERE WILL BE A GAP BETWEEN THE FRONT TOW HITCH RECEIVER BRACKET AND THE MAIN MOUNTING. USE THE SUPPLIED SPACERS TO FILL THIS GAP.
- STEP 12:** WHEN FITTING THE LEFT AND RIGHT INNER FENDER SUPPORT COVERS MAKE SURE THE COVERS ARE ON THE OUTSIDE OF THE BULLBAR AND NUT PLATES ON THE INSIDE OF THE BULLBAR.
- STEP 13:** AFTER BULLBAR IS BOLTED AND SECURE. YOU CAN FIT THE SMALL FRONT SKID AND THE CONNECTION BRACKET TO STANDARD SKID.
- STEP 14:** USE SMALL SKID NUT PLATE TO BOLT THE SMALL SKIDPLATE ONTO THE BULLBAR.
- STEP 15:** BOLT NUMBER PLATE BRACKET ONTO THE FRONT OF THE BULLBAR USING PROVIDED BOLTS. IF THERE IS A WINCH FITTED NUMBER PLATE BRACKET IS NOT USED.
- STEP 16:** USE PROVIDED GRILL BRACKETS AS SHOWN ON **PAGE 4** TO HOLD GRILL IN POSITION AFTER THE CUT ON THE GRILL WAS MADE ACCORDING TO THE PROVIDED CUTTING INSTRUCTION. (**NB!!** LEGEND AND RAIDER GRILLS DIFFER, USE CORRECT CUTTING INSTRUCTION AND GRILL BRACKETS)
- STEP 17:** AFTER BULLBAR IS FITTED CUT THE EXCESS RUBBER TRIM PARRALEL TO THE BODY SHAPE.

# TOYOTA HILUX LEGEND / RAIDER

## FITMENT INSTRUCTION



USE STANDARD BOLTS OF VEHICLE IN HOLES INDICATED  
 ADD 2 x M10 L/F WASHERS TO BOLTS  
 USE 2 x M10 x 30mm BOLTS, 2 x M10 L/F WASHERS,  
 2 x M10 NYLOCK NUTS IN THE OTHER HOLES

2 x M10 x 100mm BOLTS  
 2 x M10 L/F WASHERS  
 2 x M10 SD WASHERS  
 2 x M10 NYLOCK NUTS

2 x M12 x 40 x 1.25 BOLTS  
 2 x M12 L/F WASHERS  
 2 x M12 SPRING WASHERS

USE STANDARD BOLTS OF VEHICLE IN HOLES INDICATED  
 ADD 2 x M10 L/F WASHERS TO BOLTS  
 USE 2 x M10 x 30mm BOLTS, 2 x M10 L/F WASHERS,  
 2 x M10 NYLOCK NUTS IN THE OTHER HOLES

2 x M10 x 100mm BOLTS  
 2 x M10 L/F WASHERS  
 2 x M10 SD WASHERS  
 2 x M10 NYLOCK NUTS

2 x M12 x 40 x 1.25 BOLTS  
 2 x M12 L/F WASHERS  
 2 x M12 SPRING WASHERS

2 x M8 x 30 x 1.25 SET SCREW  
 2 x M8 SPRING WASHER  
 2 x M8 x 24 x 2 WASHER

3 x M6 x 30 SET SCREW  
 6 x M6 x 24 x 2 WASHER  
 3 x M6 NYLOCK NUT

2 x M8 x 30 x 1.25 SET SCREW  
 2 x M8 SPRING WASHER  
 2 x M8 x 24 x 2 WASHER

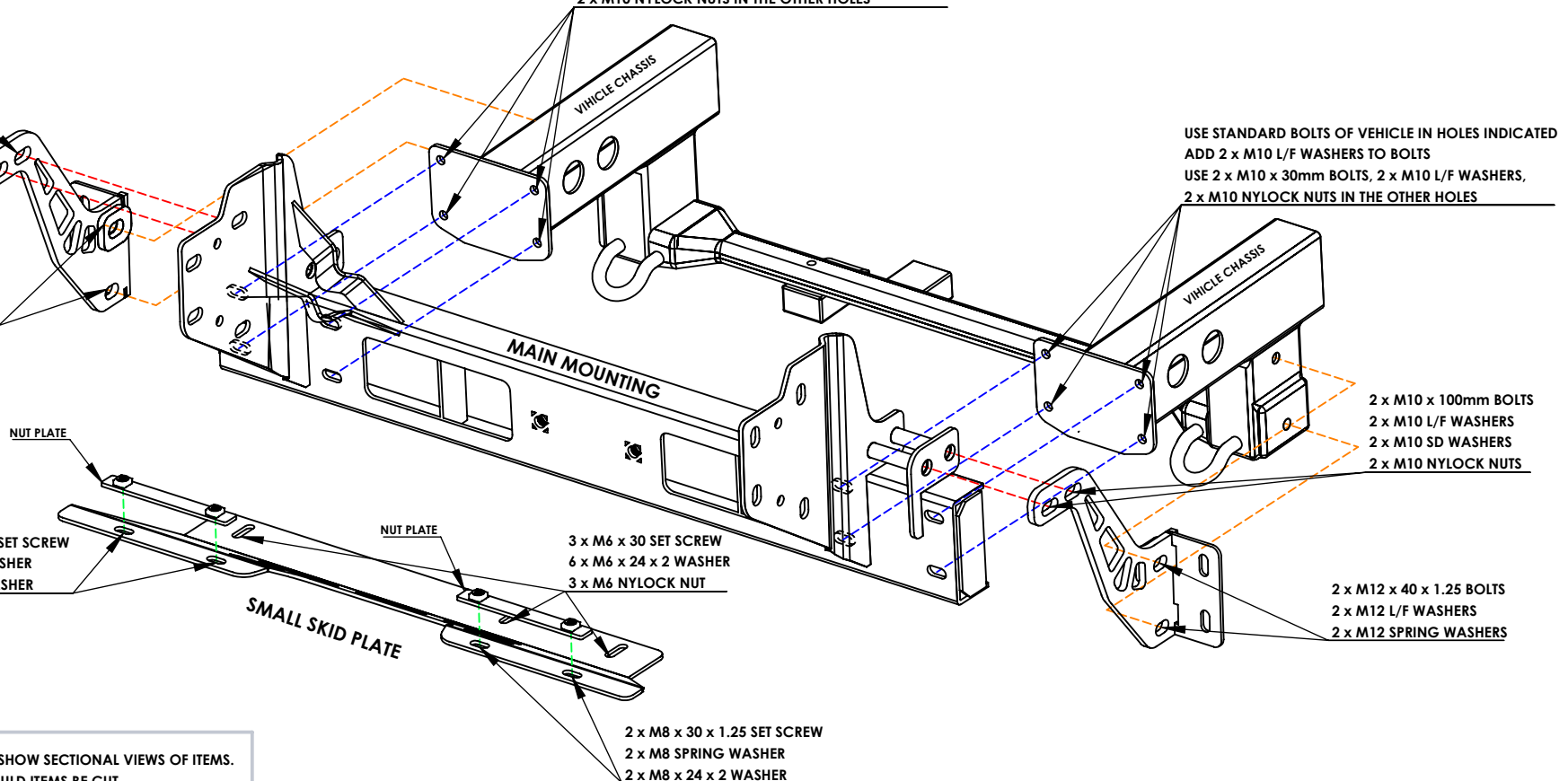

FITMENT INSTRUCTION DRAWING SHOW SECTIONAL VIEWS OF ITEMS.  
 UNDER NO CIRCUMSTANCES SHOULD ITEMS BE CUT.

NEVER CUT OR STRUCTURALLY MODIFY ANY ONCA PRODUCTS  
 OR VEHICLE COMPONENTS TO DO A FITMENT.

ONCA PRODUCTS ARE VEHICLE SPECIFIC DESIGNED PRODUCTS.

ALL THE MOUNTING POINTS, BOLTS, BRACKETS AND WASHERS  
 MUST BE USED TO ENSURE CORRECT FITMENT OF THIS PRODUCT.

FOR MORE INFO REGARDING THE FITMENT OF THIS PRODUCT.  
 TELL: +2711 979-2690  
 E-MAIL: sales@onca4x4.co.za

**IMPORTANT:** PLEASE CONTACT ONCA OFFICE FOR GRILL CUTTING INSTRUCTIONS AND GRILL PLACEMENT PICTURES. GRILL INSTRUCTIONS CAN BE MAILED OR SEND ON WHATSAPP. (CONTACT NUMBER: (011) 979 2690)

# TOYOTA HILUX LEGEND / RAIDER

## FITMENT INSTRUCTION



**NOTE:**

- WHEN BRACKET SYSTEM IS BOLTED IN TO POSITION.
- SLIDE BULLBAR OVER MAIN MOUNTING.
- BOLT THE BULLBAR INTO POSITION USING THE (4 x) M10 x 30 SET SCREW, (8 x) M10 x 30 x 3 WASHERS AND (4 x) M10 NYLOCK NUTS ON THE LEFT AND RIGHT
- REMOVE BULLBAR FOR DRILLING
- SCRIBE HOLES ONTO MAIN MOUNTING AND BULLBAR. DRILL  $\varnothing$  10.5mm HOLES IN SCRIBED LOCATION.
- SLIDE BULLBAR BACK INTO POSITION AND BOLT DOWN BULLBAR USING ALL THE MAIN MOUNTING AND LOCATION HOLES.

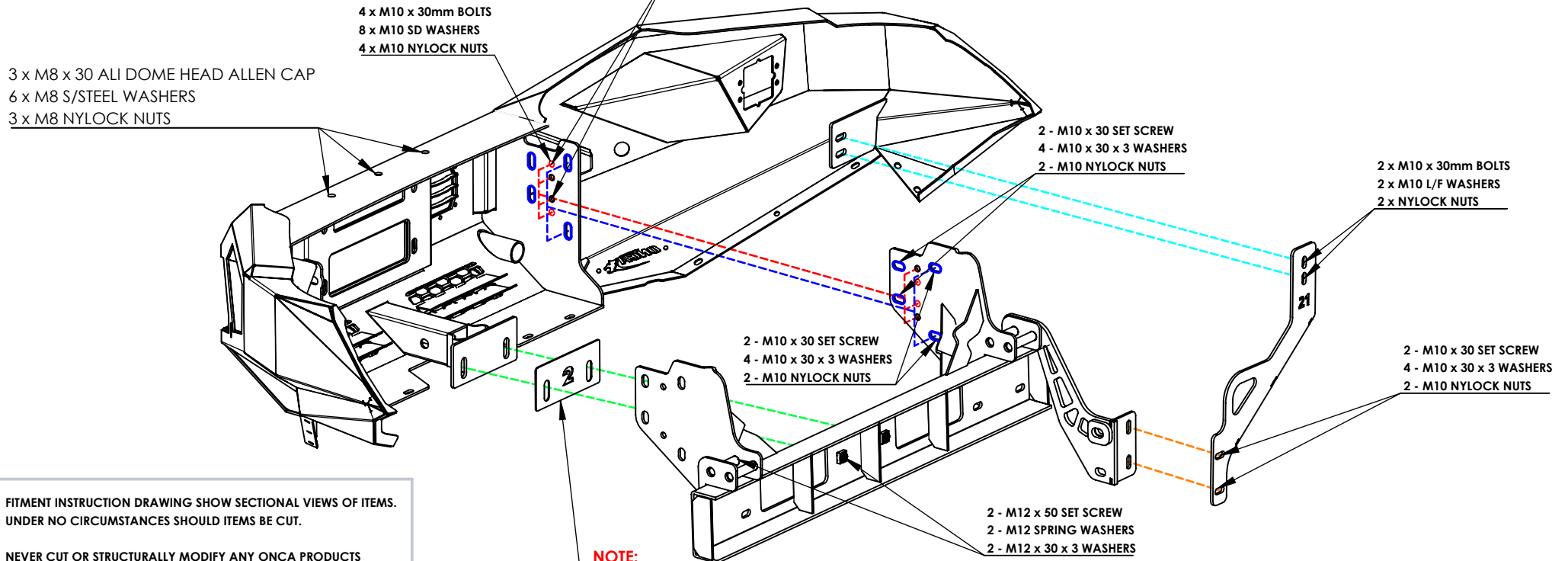

FITMENT INSTRUCTION DRAWING SHOW SECTIONAL VIEWS OF ITEMS. UNDER NO CIRCUMSTANCES SHOULD ITEMS BE CUT.

NEVER CUT OR STRUCTURALLY MODIFY ANY ONCA PRODUCTS OR VEHICLE COMPONENTS TO DO A FITMENT.

ONCA PRODUCTS ARE VEHICLE SPECIFIC DESIGNED PRODUCTS.

ALL THE MOUNTING POINTS, BOLTS, BRACKETS AND WASHERS MUST BE USED TO ENSURE CORRECT FITMENT OF THIS PRODUCT.

FOR MORE INFO REGARDING THE FITMENT OF THIS PRODUCT.  
TELL: +2711 979-2690  
E-MAIL: sales@onca4x4.co.za

**NOTE:**

- WHEN THE BULLBAR IS IN POSITION AND FORMS A PARALLEL GAP THERE WILL NORMALLY BE A GAP BETWEEN THE FRONT TOWHITCH RECEIVER BRACKET AND THE MAIN MOUNTING.
- USE THE SUPPLIED SPACERS TO FILL UP THIS GAP

**IMPORTANT:** PLEASE CONTACT ONCA OFFICE FOR GRILL CUTTING INSTRUCTIONS AND GRILL PLACEMENT PICTURES. GRILL INSTRUCTIONS CAN BE MAILED OR SEND ON WHATSAPP. (CONTACT NUMBER: (011) 979 2690)

# TOYOTA HILUX LEGEND / RAIDER

## FITMENT INSTRUCTION



### NOTE:

NUT PLATES TO BE PLACED ON THE INSIDE OF THE BULLBAR.

COVER PLATE IS PLACED ON THE OUTSIDE AND BOLTED ON WITH PROVIDED BOLTS

2 x M8 x 25mm S/S DOME HEAD ALLEN BOLTS  
2 x M8 x S/S SPRING WASHERS  
2 x M8 SD WASHERS

3 x M8 x 25mm S/S DOME HEAD ALLEN BOLTS  
3 x M8 x S/S SPRING WASHERS  
2 x M8 SD WASHERS

3 x M8 x 25mm S/S DOME HEAD ALLEN BOLTS  
3 x M8 x S/S SPRING WASHERS  
3 x M8 SD WASHERS

FITMENT INSTRUCTION DRAWING SHOW SECTIONAL VIEWS OF ITEMS.  
UNDER NO CIRCUMSTANCES SHOULD ITEMS BE CUT.

NEVER CUT OR STRUCTURALLY MODIFY ANY ONCA PRODUCTS  
OR VEHICLE COMPONENTS TO DO A FITMENT.

ONCA PRODUCTS ARE VEHICLE SPECIFIC DESIGNED PRODUCTS.

ALL THE MOUNTING POINTS, BOLTS, BRACKETS AND WASHERS  
MUST BE USED TO ENSURE CORRECT FITMENT OF THIS PRODUCT.

FOR MORE INFO REGARDING THE FITMENT OF THIS PRODUCT.  
TELL: +2711 979-2690  
E-MAIL: sales@onca4x4.co.za

**IMPORTANT:** PLEASE CONTACT ONCA OFFICE FOR GRILL CUTTING INSTRUCTIONS AND GRILL PLACEMENT PICTURES. GRILL INSTRUCTIONS CAN BE MAILED OR SEND ON WHATSAPP. (CONTACT NUMBER: (011) 979 2690)

# TOYOTA HILUX LEGEND / RAIDER FITMENT INSTRUCTION

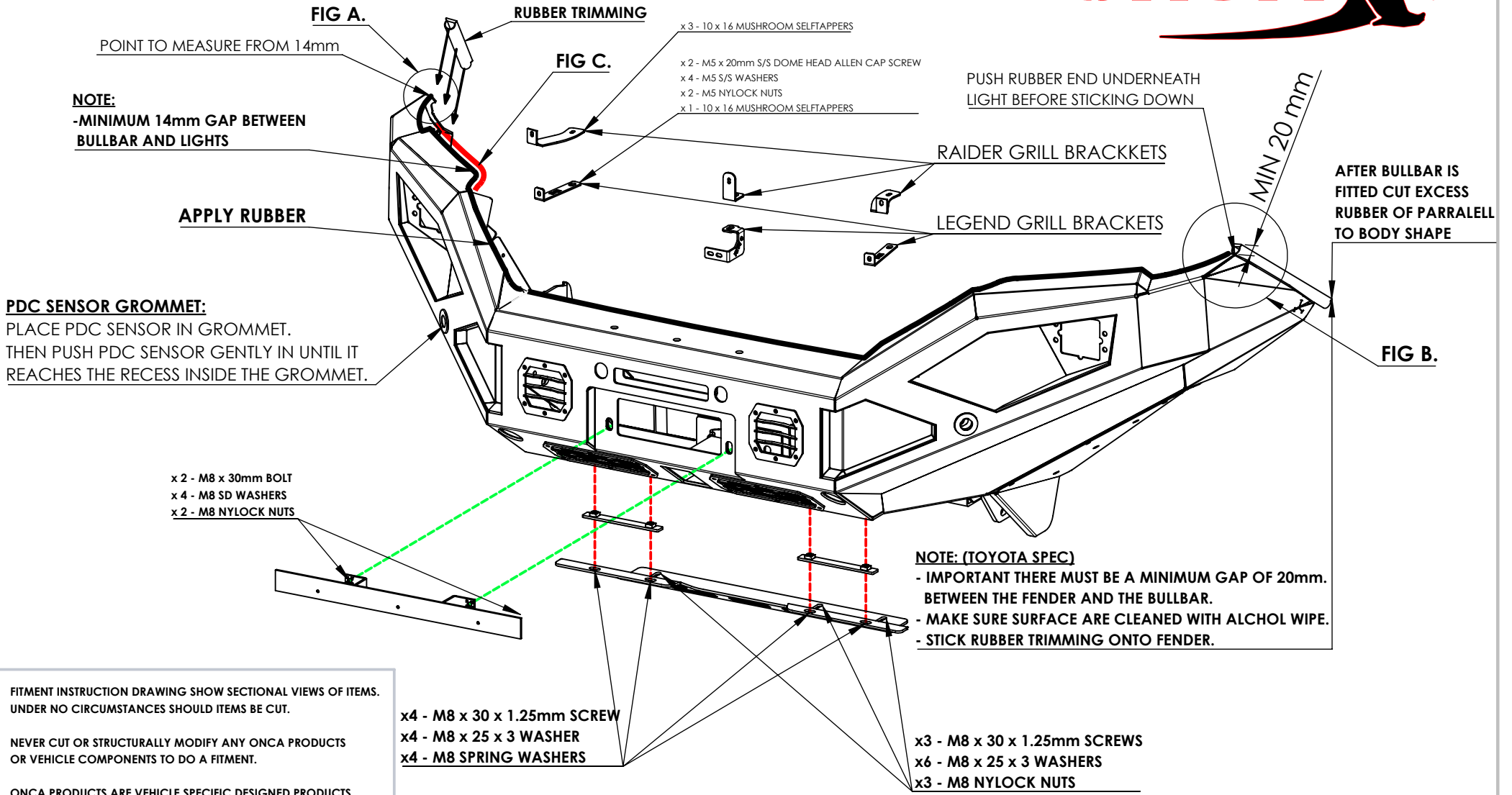

FITMENT INSTRUCTION DRAWING SHOW SECTIONAL VIEWS OF ITEMS. UNDER NO CIRCUMSTANCES SHOULD ITEMS BE CUT.

NEVER CUT OR STRUCTURALLY MODIFY ANY ONCA PRODUCTS OR VEHICLE COMPONENTS TO DO A FITMENT.

ONCA PRODUCTS ARE VEHICLE SPECIFIC DESIGNED PRODUCTS.

ALL THE MOUNTING POINTS, BOLTS, BRACKETS AND WASHERS MUST BE USED TO ENSURE CORRECT FITMENT OF THIS PRODUCT.

FOR MORE INFO REGARDING THE FITMENT OF THIS PRODUCT.  
TELL: +2711 979-2690  
E-MAIL: sales@onca4x4.co.za

**IMPORTANT:** PLEASE CONTACT ONCA OFFICE FOR GRILL CUTTING INSTRUCTIONS AND GRILL PLACEMENT PICTURES. GRILL INSTRUCTIONS CAN BE MAILED OR SEND ON WHATSAPP. (CONTACT NUMBER: (011) 979 2690)





